

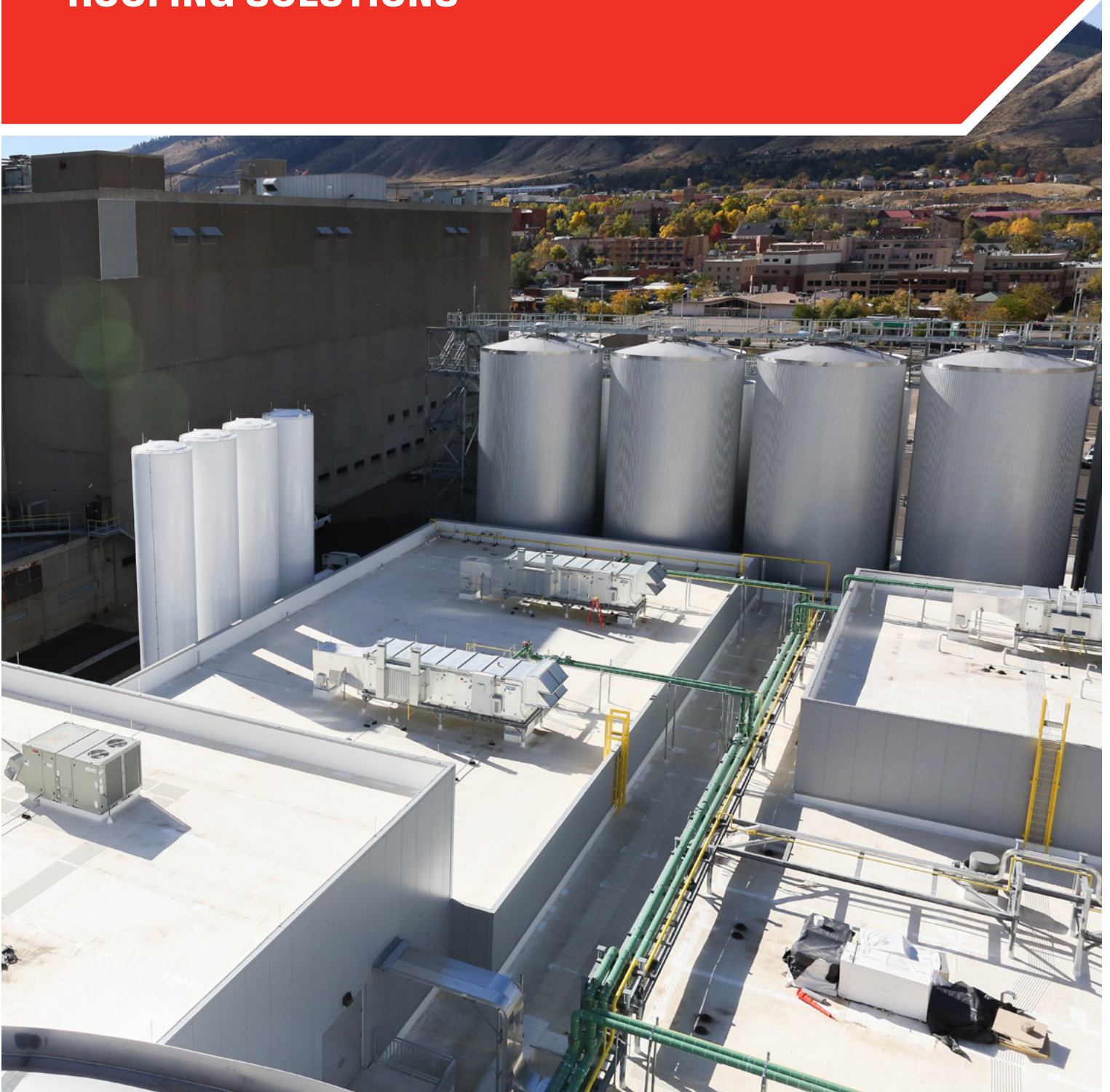

# COLD STORAGE BUILDING ROOFING SOLUTIONS





## COLD STORAGE ROOFS REQUIRE SPECIFIC SYSTEMS AND EXPERTISE

**Elevate™ products are engineered to provide operational security to the mission-critical facilities the world depends on.**

Cold storage warehouses are defined as buildings with inside temperatures that range between 40° and -50°F (4.4 and -45.5°C). These structures are often responsible for preserving fresh foods or the shelf life of medicines and play a critical role in supply chain. These buildings are surging in demand, and with installations across the country and around the world, they require engineered solutions to address the unique design challenges created by sustained low interior temperatures, elevated exterior relative humidity, and the resulting vapor pressure differentials and air leakage pathways between these environments..

These factors directly affect the roof of cold storage buildings that need to perform 24 hours a day, across seasons and often many years. Conditions can be managed with the right roof system that not only provides thermal and waterproofing performance, but also includes components that keep vapor out of the building and roof system. The right roof assembly designed for cold storage facilities is critical for long-term system performance and energy savings.



## ELEVATE™ HAS COVERED MILLIONS OF SQUARE FEET OF COLD STORAGE BUILDINGS



Elevate™ delivers premium cold storage roofing solutions. Over the years, more than 20 million warranted square feet on cold storage buildings have been installed across the United States and Canada alone.

This includes high profile buildings across the country in various climates. Elevate understands the complexities of cold storage buildings, and we have the product portfolio unique high-performance system solutions, codes expertise, and logistics to meet the requirements of the most complex demanding cold storage projects.

## ELEVATE™ PRODUCTS ENGINEERED TO PERFORM

Our extensive portfolio of roofing membrane, insulation, recovery board and vapor barrier is able to meet a large variety of designs to suit your cold storage facility specifications.

- UltraPly™ TPO
- UltraPly™ TPO SA
- Elevate™ MAX™ PVC
- Elevate™ PVC KEE
- RubberGard™ EPDM
- RubberGard™ EPDM SA
- Elevate™ Asphalt

For over 45 years, Elevate RubberGard™ EPDM membranes have performed and offered a low perm rating, minimizing vapor transmission through the roof cover.

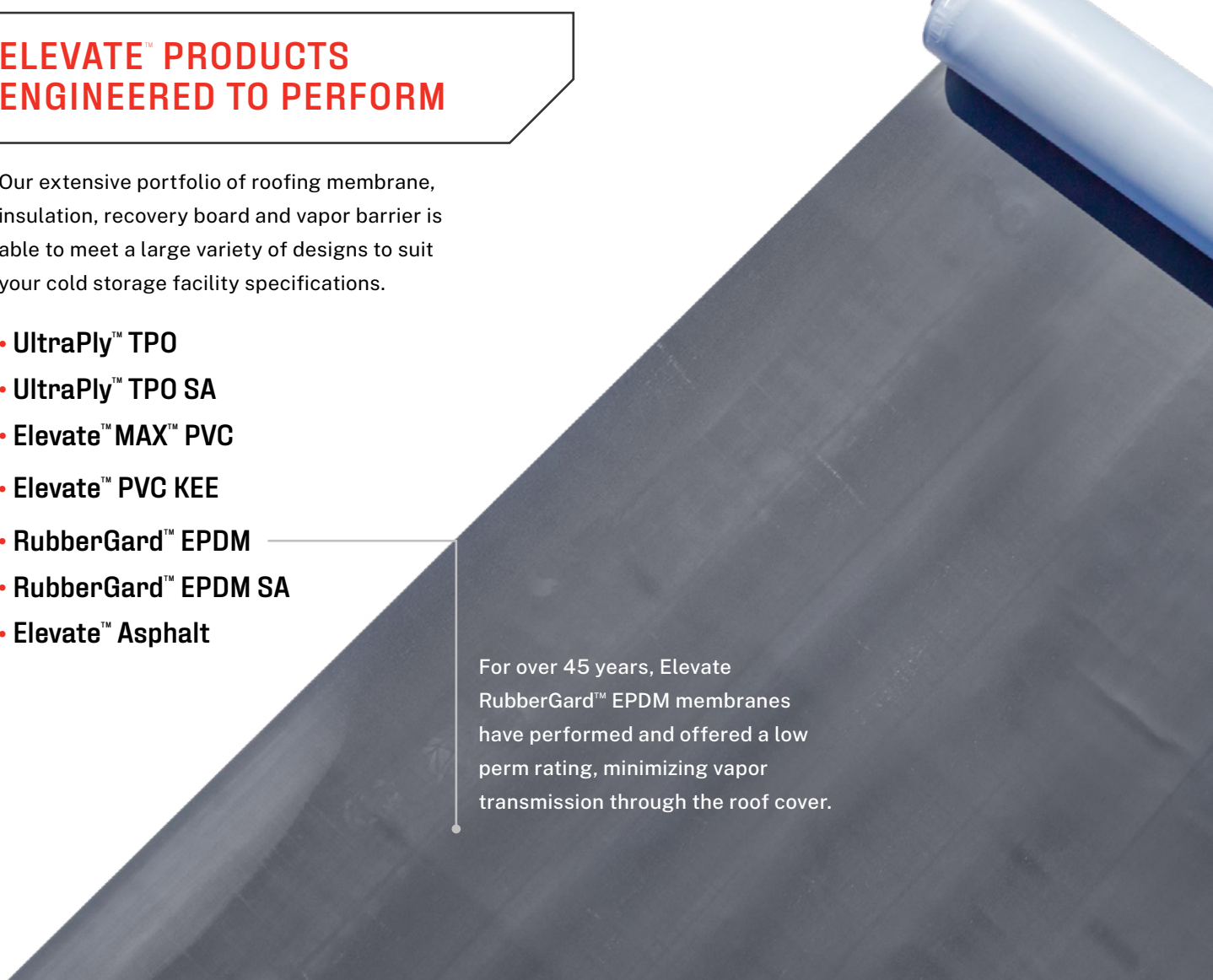
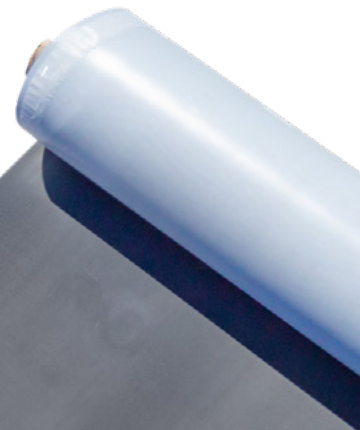

# ISOGARD POLYISO INSULATION

As the next generation of polyiso insulation, Elevate™ ISOGARD and its patented formula are your elite choice for cold storage applications. A cold storage warehouse is permanently refrigerated so roof assemblies must be able to perform at cold temperatures, and Elevate ISOGARD insulation is engineered to perform in these situations. ISOGARD powers the performance of Elevate™ roof assemblies by outperforming the competition by more than 40%. Its patented formulation has been engineered to increase R-value compared to any industry standard polyiso insulation (ASTM C1289).

This translates into energy savings to keep your assets cool.

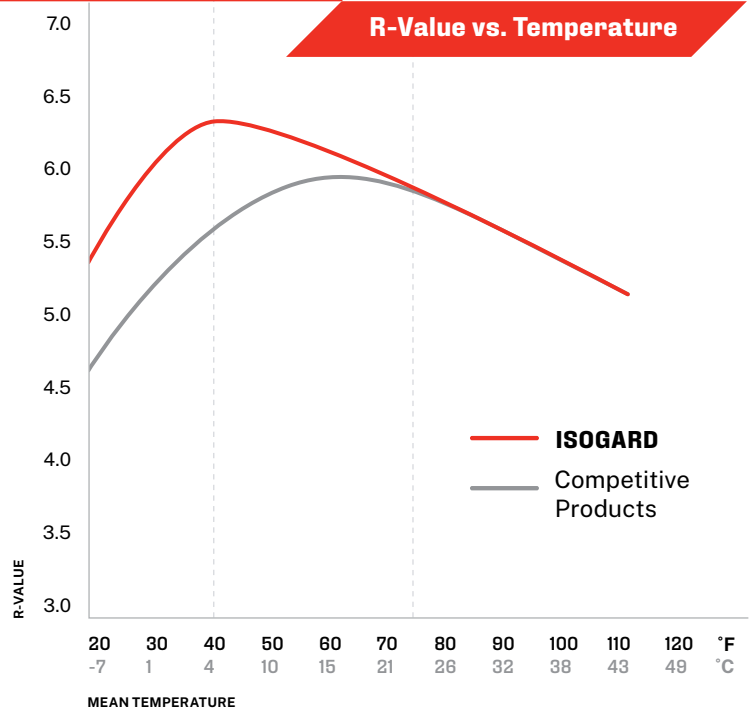

## UP TO 40% BETTER THERMAL PERFORMANCE

ISOGARD delivers up to 40% better thermal performance in colder mean temperatures than the competition\*



## HIGHEST R-VALUE PER INCH

Meets both ASTM requirements and recommended thermal performance values. Competing polyiso boards require additional thickness to achieve the same R-value at low mean temperatures



## ENERGY EFFICIENT

ISOGARD offers an efficient insulation system, reducing building energy use and associated greenhouse gas emissions

\* The thermal performance of Elevate's ISOGARD polyiso insulation is up to 40% better than major competitors when tested by an independent third party in cold environments with a mean temperature of 40°F (4°C) applications according to ASTM C1289 standards. The increased R-value per inch means better thermal performance from the same roofing systems using the same amount of insulation compared to leading competitive products on the market today.

\*\* Potential savings are only estimates; actual performance attributes vary based on many factors, including specific building features like skylights, wall insulation, and HVAC performance. Energy savings were estimated using an industry-recognized tool adjusting insulation thermal performance at 40°F (4°C) and applying it to the number of heating days. Consult with a competent mechanical engineer and/or roofing professional for more tailored savings estimates.

# COLD STORAGE ROOFING ASSEMBLY EXAMPLES

Elevate™ commercial roofing systems are designed to work as complete systems and can be combined to meet a wide range of design specifications.

Elevate offers thousands of assembly combinations with a variety of code approved systems and warranty options including adhered, ballasted, and mechanically attached applications. For alternative assemblies or to confirm compatibility with Elevate Red Shield Limited Warranties, please contact your Elevate representative.

PLEASE NOTE: The below images are examples of various system possibilities. Specific design and R-value requirements for building types may call for varying layers of insulation. Appropriate air/vapor control layer location are determined by the designer.



Visit our website to take advantage of our extensive designer resources including: details, quick spec and design guides.

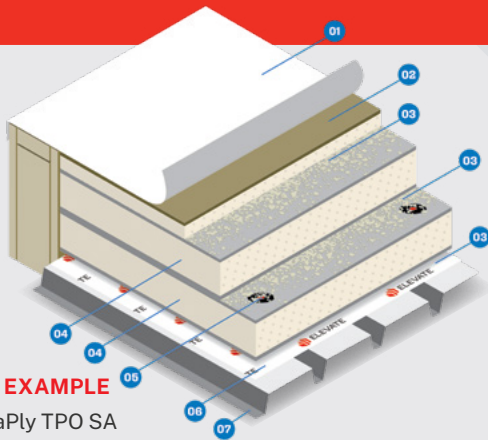

## TPO SA SYSTEM EXAMPLE

- 01 UltraPly TPO SA
- 02 ISOGARD HD Insulation
- 03 Approved Elevate Insulation Adhesive
- 04 ISOGARD GL Insulation
- 05 Approved Elevate Plates and Fasteners
- 06 Appropriate Air / Vapor Control Layer (optional)
- 07 Roof Deck

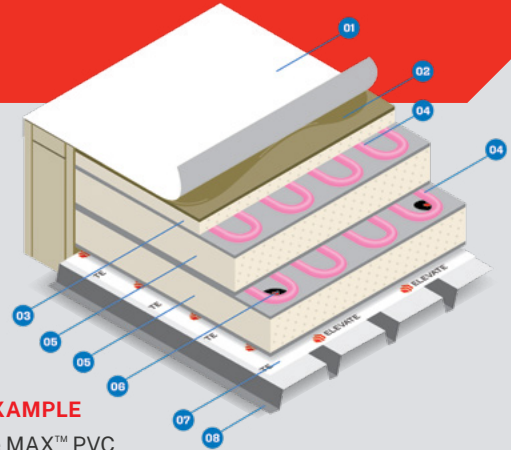

## PVC SYSTEM EXAMPLE

- 01 Elevate MAX™ PVC
- 02 Approved Elevate Membrane Adhesive
- 03 ISOGARD HD Insulation
- 04 Approved Elevate Insulation Adhesive
- 05 ISOGARD GL Insulation
- 06 Approved Elevate Plates and Fasteners
- 07 Appropriate Air / Vapor Control Layer (optional)
- 08 Roof Deck

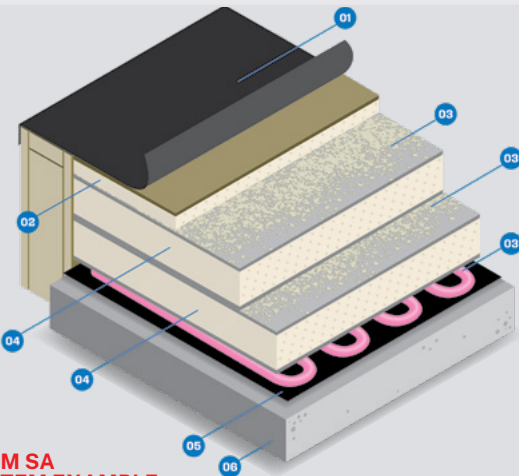

## EPDM SA SYSTEM EXAMPLE

- 01 RubberGard EPDM SA
- 02 ISOGARD HD Insulation
- 03 Approved Elevate Insulation Adhesive
- 04 ISOGARD GL Insulation
- 05 Elevate APP 160
- 06 Concrete Roof Deck

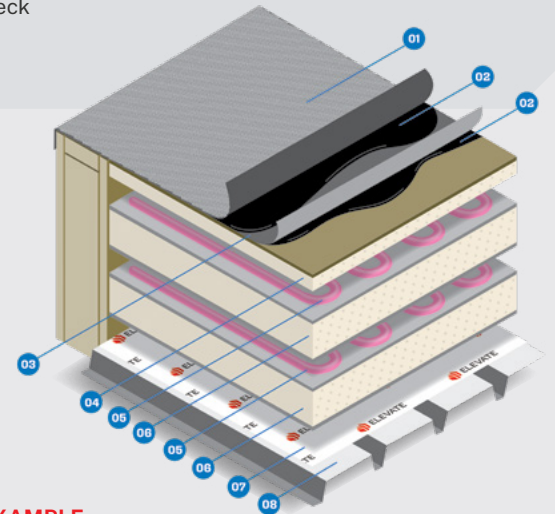

## ASPHALT SYSTEM EXAMPLE

- 01 Elevate Smooth or Granule Surfaced Cap Sheet
- 02 Hot Bitumen Mopping, Torched or Cold Adhesive
- 03 Elevate Base Sheet
- 04 ISOGARD HD Cover Board
- 05 Elevate Foam Insulation Adhesive
- 06 ISOGARD GL Insulation
- 07 Appropriate Air / Vapor Control Layer (optional)
- 08 Roof Deck

# RECOMMENDED COLD STORAGE SOLUTIONS

## CONTROL LAYERS

Managing the extreme environmental differences between the interior and exterior of cold storage buildings requires well-designed roof assemblies that integrate reliable air, vapor, and thermal control layers.

Elevate provides the integrated materials needed to create these critical control layers within the roofing system. Substrate compatibility, fire performance, and installation method are key considerations to ensure these layers perform as intended, with options available for direct-to-deck applications, enhanced fire design requirements, and jobsite conditions such as exposure duration or phased construction.

System selection and placement of the air/vapor control layer should be determined by the design professional based on assembly configuration and project-specific conditions.

## FLASHING FOAM

Designed for cold storage, our flashing foam creates airtight seals at curbs, penetrations, and transitions to reduce air infiltration, limit thermal bridging, and helps prevent accumulations of water vapor that are subject to freeze / thaw cycles.



Elevate V-Force Vapor barrier

### CLASS 1 VAPOR RETARDERS PERMEABILITY RATINGS

**V-Force FR** 0.017 perm

**V-Force** 0.04 perm

**APP 160** 0.015 perm



Elevate Flashing Foam

# SUGGESTED MINIMUM R-VALUES FOR ROOF INSULATION\*

COLD STORAGE TYPE	INTERIOR TEMPERATURE RANGE °F (°C)	MINIMUM R-VALUE FOR ROOF INSULATION
<b>Coolers</b>	40 to 50 (4.4 to 10)	30 to 35
<b>Chill Coolers</b>	25 to 35 (-3.8 to 1.6)	35 to 40
<b>Holding Freezers</b>	-10 to -20 (-23.3 to -28.9)	45 to 50
<b>Blast Freezers</b>	-40 to -50 (-40 to -45.5)	50 to 60

\*2022 edition of the American Society of Heating, Refrigerating and Air-Conditioning Engineers' ASHRAE Handbook—Refrigeration

# NOBODY COVERS YOU BETTER™

## RED SHIELD™ LIMITED WARRANTIES

Working with a reputable manufacturer like Elevate means more than just having high-quality products installed from the most trusted name in commercial building products. It also means you have the ability to protect this important asset with unsurpassed warranty coverage. Just as there is an Elevate system for every cold storage building, there is also an Elevate Red Shield warranty for every building, every system and every budget.

Our Elevate Red Shield Limited Warranty stands alone among the competition. Among the many benefits of the Red Shield Limited Warranty are material and labor coverage with comprehensive, no-dollar limit liability; “edge-to-edge” system coverage including membrane, insulation and metal; and coverage that is transferable from owner-to-owner. Depending on the commercial roof system, the terms of the warranty can range up to 30 years.

ELEVATE  
RED SHIELD

UP TO

30 YEAR  
WARRANTY





# ELEVATE

NOBODY COVERS YOU BETTER™

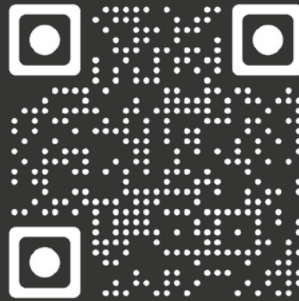

SCAN FOR FULL  
COLD STORAGE  
RESOURCES

Learn more at [ElevateCommercialBP.com](https://ElevateCommercialBP.com).

© 2026 Amrize. All Rights Reserved.

3023 04/2026



Elevate is part of the Amrize family of brands